

FAG

61806

Deep groove ball bearing

Schaeffler ID:
0554570450000Deep groove ball bearing 618, single row,
steel sheet metal cage

Technical information

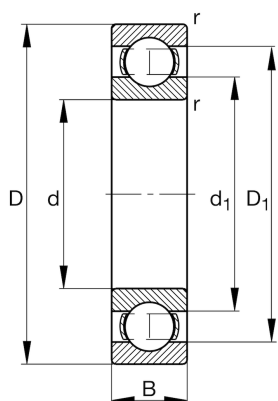
**Dimensions**

r_{\min}	0.3 mm	Minimum chamfer dimension
D_1	38.2 mm	Shoulder diameter outer ring
d_1	33.1 mm	Shoulder diameter inner ring
	22 g	Weight

Main Dimensions & Performance Data

d	30 mm	Bore diameter
D	42 mm	Outside diameter
B	7 mm	Width
C_r	4,450 N	Basic dynamic load rating, radial
C_{0r}	3,440 N	Basic static load rating, radial
C_{ur}	154 N	Fatigue load limit, radial
n_G	24,500 1/min	Limiting speed
n_{gr}	11,500 1/min	Reference speed

Mounting dimensions

$d_{a\min}$	32 mm	Minimum diameter shaft shoulder
$D_{a\max}$	40 mm	Maximum diameter of housing shoulder
$r_{a\max}$	0.3 mm	Maximum fillet radius

Calculation factors

f_0	16.5	Calculation factor
-------	------	--------------------

Temperature range

T_{\min}	-30 °C	Operating temperature min.
T_{\max}	120 °C	Operating temperature max.